

375 HIGH PRESSURE PRI®

The Lee Company's new 375 High Pressure PRI is a relief valve designed for optimal performance in applications with high backpressure. This new relief valve has shown stable relief flow performance in applications with backpressures up to 850 psig. It features a durable tungsten carbide ball with the remaining components constructed entirely of stainless steel.

Available in forward and reverse relief flow directions, the 375 High Pressure PRI offers a range of cracking pressures for 3000, 4000 and 5000 psi systems with system peak pressures up to 6750 psi. Each relief valve is 100% tested and inspected to ensure reliable, consistent performance.

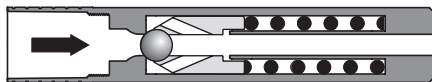

RELIEF FLOW FORWARD

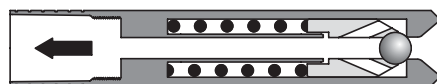

RELIEF FLOW REVERSE

MATERIALS		
PART	MATERIAL	SPECIFICATION
Body	304 CRES	AMS 5639
Pin	17-4PH CRES	AMS 5643
Poppet	304 CRES	AMS 5639
Seat	440C CRES	AMS 5630
Spring	17-7PH CRES	AMS 5678
Ball	Tungsten Carbide	-
Retainer	15-5PH CRES	AMS 5659
Tube	13-8 MO CRES	AMS 5629
Orifice Plate	304 CRES	AMS 5639
Shim	17-7PH CRES	AMS 5529

Finish: All CRES Parts Passivated.
 Pins are prewaxed. Do not degrease.
 Do not lubricate.

- Durable tungsten carbide ball and 440C CRES seat
- Weighs only 20 grams
- 100% tested and inspected
- Designed for system pressures up to 5000 psi

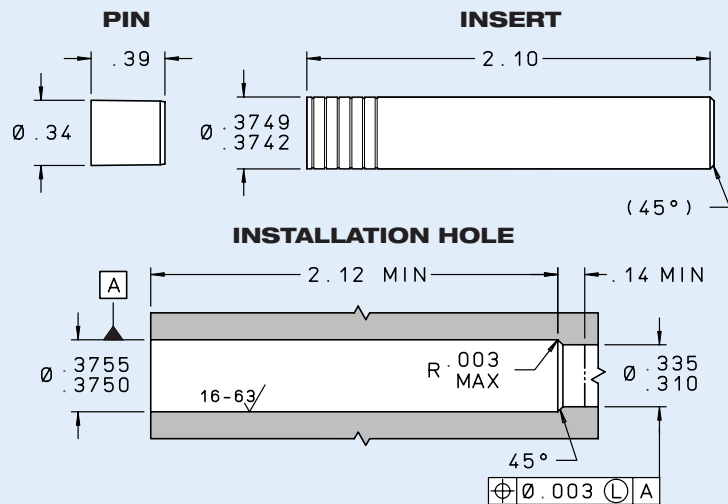

LEE PART NUMBER		MINIMUM CRACKING PRESSURE (psid)	FLOW POINT			MINIMUM SHUTOFF PRESSURE (psid)
FORWARD	REVERSE		LOHM* RATE	MIN. FLOW (gpm)	AT (psid)	
PHFA3751300D	PHRA3751300D	3000	400	3.7	3850	2850
PHFA3751320D	PHRA3751320D	3200	400	3.8	4050	3000
PHFA3751340D	PHRA3751340D	3400	400	3.9	4250	3200
PHFA3751420D	PHRA3751420D	4200	400	4.0	5250	4000
PHFA3751440D	PHRA3751440D	4400	400	4.1	5400	4200
PHFA3751520D	PHRA3751520D	5200	400	4.9	6550	5000
PHFA3751540D	PHRA3751540D	5400	400	5.0	6750	5200

PERFORMANCE	
Leakage at Minimum Cracking Pressure: 2 mL/min maximum
Leakage at Minimum Shutoff Pressure: 2 mL/min maximum
Restriction at Minimum Recommended Valve Lift: 1500 Lohms
Nominal System Pressure: 5000 psi maximum
System Peak Pressure: 6750 psi maximum
Nominal Weight: 20 grams
<i>Valve performance on MIL-PRF-83282 or MIL-PRF-5606 at 85°F ± 15°F</i>	

* The Lohm is a measure of flow resistance.
 Additional information can be found at www.TheLeeCo.com