

LO-LOHM LATCHING 3-PORT HIGH DENSITY INTER- FACE (HDI) SOLENOID VALVE

The Lee Company continues to expand its High Density Interface (HDI) solenoid valve platform by combining the high flow capabilities of the Lo-Lohm design with the power savings of our Latching design, all within a compact footprint. After supplying only a momentary (10 ms minimum) voltage pulse, this magnetically-latched solenoid valve will hold its flow state until a follow-on momentary voltage pulse (with reverse polarity) is applied to switch its flow direction. Aside from the momentary pulse, no power is consumed while maintaining each flow state.

This ultra-low heat and low power 3-port valve is optimized for compact, battery powered instruments such as portable respiratory therapy devices, molecular diagnostic instruments, environmental gas samplers and other OEM flow switching devices where high flow capacity, low power and small size are critical.

The Lee Company offers an array of standard manifolds for testing as well as custom designed manifold configurations for production. Performance parameters can be optimized for a specific application. Contact your Lee Sales Engineer for additional technical assistance and application information.

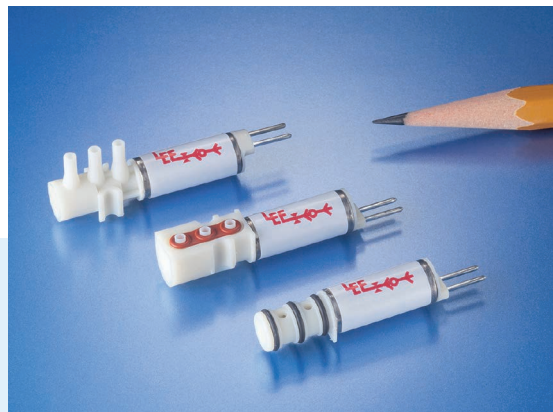

- Magnetically Latched
- Ultra Low Power Consumption (as low as 28 mJ/switch)
- High Flow Capacity
- Reliable Bi-Stable Switching
- Compact Size
- Operating Pressure Range: Vac - 45 psig (0 - 15 psid)
- Light Weight: Less than 4.5 grams
- Leakage: Less than 50 μ LPM at 5 psid (air) throughout rated cycle life
- Cycle Life: 10 million cycles minimum
- Wetted Materials: Housing (PBT), Plunger Head (PPS), Armature/Stop (FeCr Alloy), Spring (316 SS), Seal (Silicone), Epoxy, O-rings on Plug-in Style Valves (FKM)

| STYLE | PART NUMBER | VOLTAGE ¹ (Vdc) | LOHM RATE ² ON AIR AT 70°F (21°C) | POWER CONSUMPTION ³ AT 70°F (21°C) (mJ/switch) |
|------------|--------------|----------------------------|---|---|
| Plug-In | LHLA0511355D | 5 | 550 Lohms (14.6 SLPM at 15 psid; Ref. Cv = 0.036) | 28 |
| | LHLA1211355D | 12 | | 35 |
| Face Mount | LHLA0521380D | 5 | 800 Lohms (10 SLPM at 15 psid; Ref. Cv = 0.025) | 28 |
| | LHLA1221380D | 12 | | 35 |
| Ported | LHLA0531380D | 5 | | 28 |
| | LHLA1231380D | 12 | | 35 |

NOTES: (1) Other voltages available upon request
 (2) The Lohm is a measure of flow resistance. Additional information can be found at www.theleeco.com
 (3) Power consumption is calculated based on a 10 ms electrical pulse.

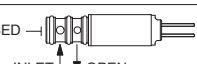
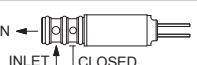
| SWITCHING TABLE | | |
|---|----------|----------|
| VALVE STATE | TERMINAL | POLARITY |
| CLOSED  | 1 | + |
| | 2 | - |
| OPEN  | 1 | - |
| | 2 | + |

The valve will switch to, and remain in the state indicated when a 10 to 30 ms electrical pulse is applied with the rated voltage and polarity.

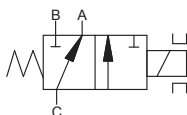

LATCHING SOLENOID VALVE SYMBOL

FLOW PERFORMANCE CHARACTERISTICS

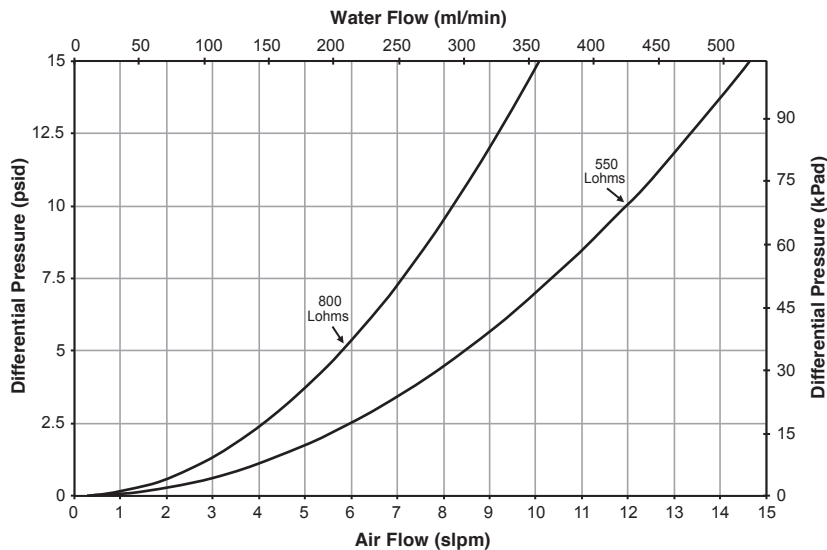

LO-LOHM LATCHING 3-PORT HDI SOLENOID VALVE

Plug-In

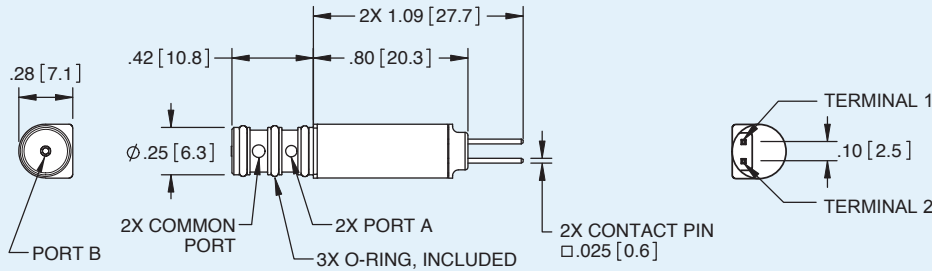

Face Mount

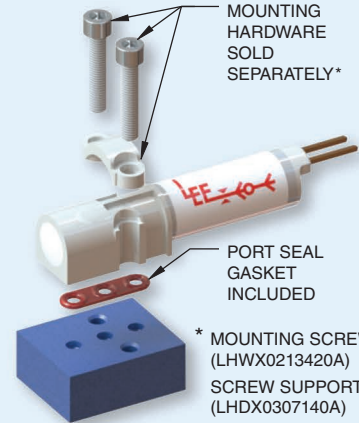
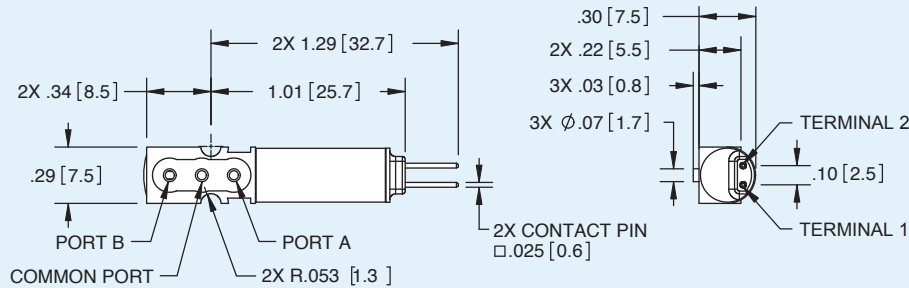

Soft Tube Ported

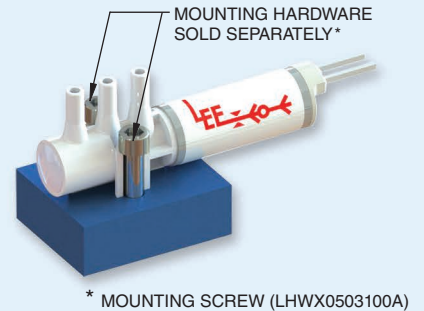
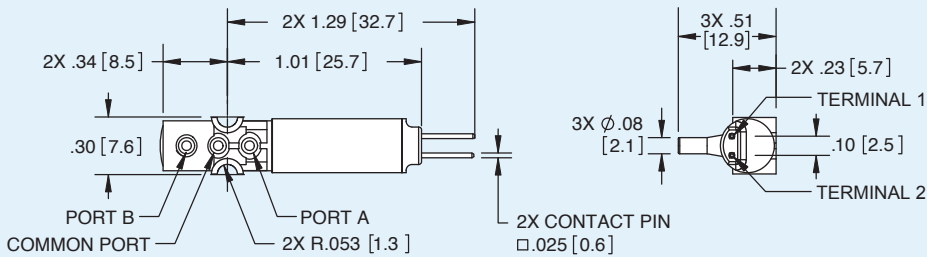

Plug-In Boss Detail

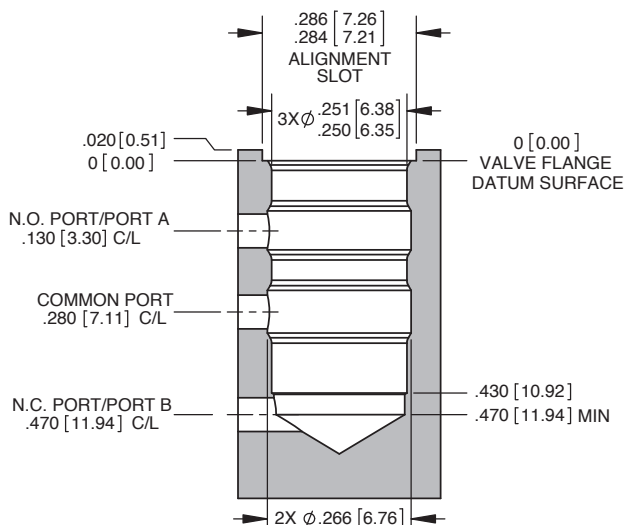

Face Mount Boss Detail

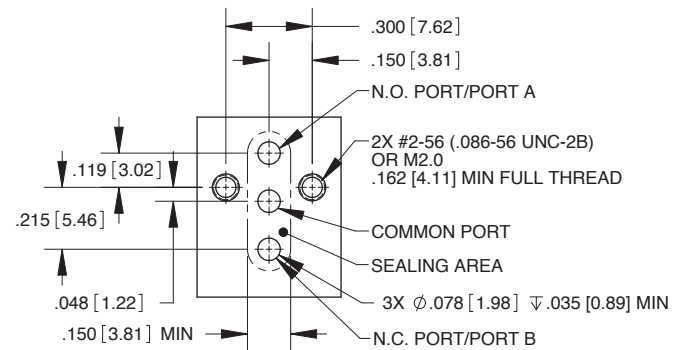

Reference Drawing Number LFIX1001150A for Face Mount Boss Details.

Reference Drawing Number LCFX0300100B for Plug-In Boss Details.
Valve Boss may be created using Lee Co. cutting tool Part No. TTTA0000180B

NOTE: Boss detail drawings not to scale.
All dimensions are in inches [mm].