

## LEE TITANIUM FLANGE MOUNT SAFETY SCREENS

The Lee Company now offers a complete line of flange mount, HI-BAR® Safety Screens made entirely of 6Al-4V Titanium. These high strength screens feature a robust, single piece construction that can withstand pressure differentials up to 7500 psid without rupture. Also, with the high strength-to-weight ratio of titanium, these screens offer a weight savings up to 43% when compared to the industry leading stainless steel Lee HI-BAR Safety Screens.

The lightweight, high strength design makes these screens ideal for applications in the aerospace, space and racing industries. Also, with the excellent corrosion resistance of 6Al-4V titanium in a variety of media including sea water, these screens are suitable for use in marine, medical and oil industry applications.

- Rugged, One Piece Design Made Entirely of 6Al-4V Titanium
- High Strength, Lightweight Design With Excellent Corrosion Resistance
- Burst/Collapse Pressure: 7500 PSID
- 36 Standard Versions for Design Flexibility
- Hole Sizes From 0.004" to 0.020"
- Custom Designs Available



These titanium HI-BAR Safety Screens are available in 6 different flange sizes ranging from 0.130" to 0.670" in diameter, and 6 different hole sizes ranging from 0.004" to 0.020" in diameter.

All Lee Safety Screens are precision cleaned and packaged before shipment. Special designs are available upon request. Contact your local Lee Sales Engineer for additional information or technical assistance.

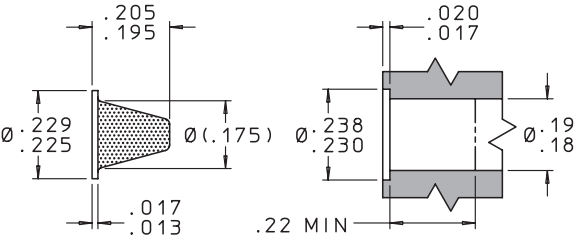
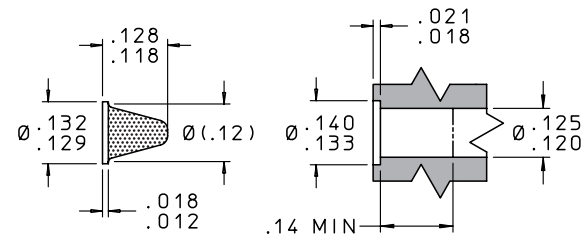

### 130 FLANGE MOUNT SCREEN

| LEE PART NUMBER | HOLE SIZE (in.) | HOLE SIZE (µm) | OPEN AREA (in. <sup>2</sup> ) | TOTAL AREA (in. <sup>2</sup> ) | NUMBER OF HOLES | BURST / COLLAPSE PRESSURE (psid min.) | Rob** NUMBER | LOHM* RATE (nom.) |
|-----------------|-----------------|----------------|-------------------------------|--------------------------------|-----------------|---------------------------------------|--------------|-------------------|
| FSHF1302010A    | 0.004           | 100            | 0.003                         | 0.02                           | 200             | 7500                                  | 0.2          | 350               |
| FSHF1302015A    | 0.006           | 150            | 0.003                         | 0.02                           | 110             | 7500                                  | 0.6          | 350               |
| FSHF1302020A    | 0.008           | 200            | 0.003                         | 0.02                           | 45              | 7500                                  | 0.8          | 300               |
| FSHF1302025A    | 0.010           | 250            | 0.003                         | 0.02                           | 40              | 7500                                  | 1.8          | 300               |
| FSHF1302040A    | 0.015           | 380            | 0.004                         | 0.02                           | 25              | 7500                                  | 7.3          | 250               |
| FSHF1302050A    | 0.020           | 500            | 0.005                         | 0.02                           | 14              | 7500                                  | 16.7         | 200               |

### 230 FLANGE MOUNT SCREEN

| LEE PART NUMBER | HOLE SIZE (in.) | HOLE SIZE (µm) | OPEN AREA (in. <sup>2</sup> ) | TOTAL AREA (in. <sup>2</sup> ) | NUMBER OF HOLES | BURST / COLLAPSE PRESSURE (psid min.) | Rob** NUMBER | LOHM* RATE (nom.) |
|-----------------|-----------------|----------------|-------------------------------|--------------------------------|-----------------|---------------------------------------|--------------|-------------------|
| FSHF2302010A    | 0.004           | 100            | 0.010                         | 0.06                           | 795             | 7500                                  | 0.8          | 95                |
| FSHF2302015A    | 0.006           | 150            | 0.010                         | 0.06                           | 350             | 7500                                  | 1.8          | 95                |
| FSHF2302020A    | 0.008           | 200            | 0.010                         | 0.06                           | 200             | 7500                                  | 3.4          | 95                |
| FSHF2302025A    | 0.010           | 250            | 0.010                         | 0.06                           | 130             | 7500                                  | 6.0          | 95                |
| FSHF2302040A    | 0.015           | 380            | 0.013                         | 0.06                           | 70              | 7500                                  | 20           | 90                |
| FSHF2302050A    | 0.020           | 500            | 0.013                         | 0.06                           | 42              | 7500                                  | 49           | 90                |

# LEE TITANIUM FLANGE MOUNT SAFETY SCREENS

## 330 FLANGE MOUNT SCREEN

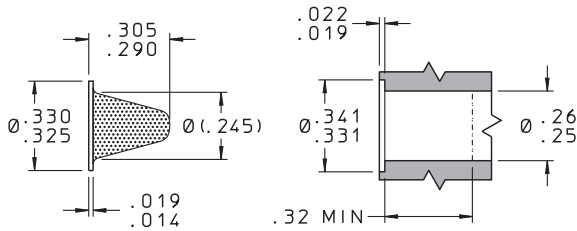

| LEE PART NUMBER | HOLE SIZE (in.) | HOLE SIZE (µm) | OPEN AREA (in.²) | TOTAL AREA (in.²) | NUMBER OF HOLES | BURST / COLLAPSE PRESSURE (psid min.) | ROB** NUMBER | LOHM* RATE (nom.) |
|-----------------|-----------------|----------------|------------------|-------------------|-----------------|---------------------------------------|--------------|-------------------|
| FSHF3302010A    | 0.004           | 100            | 0.022            | 0.12              | 1750            | 7500                                  | 1.9          | 50                |
| FSHF3302015A    | 0.006           | 150            | 0.022            | 0.12              | 778             | 7500                                  | 4.0          | 45                |
| FSHF3302020A    | 0.008           | 200            | 0.022            | 0.12              | 435             | 7500                                  | 7.4          | 45                |
| FSHF3302025A    | 0.010           | 250            | 0.022            | 0.12              | 280             | 7500                                  | 13           | 45                |
| FSHF3302040A    | 0.015           | 380            | 0.028            | 0.12              | 158             | 7500                                  | 46           | 45                |
| FSHF3302050A    | 0.020           | 500            | 0.028            | 0.12              | 90              | 7500                                  | 107          | 40                |

## 380 FLANGE MOUNT SCREEN

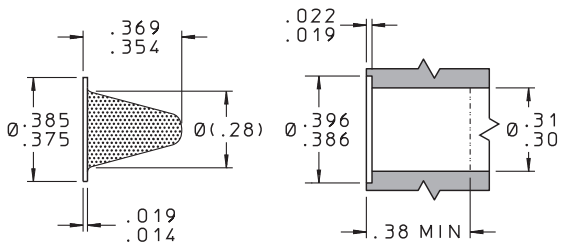

| LEE PART NUMBER | HOLE SIZE (in.) | HOLE SIZE (µm) | OPEN AREA (in.²) | TOTAL AREA (in.²) | NUMBER OF HOLES | BURST / COLLAPSE PRESSURE (psid min.) | ROB** NUMBER | LOHM* RATE (nom.) |
|-----------------|-----------------|----------------|------------------|-------------------|-----------------|---------------------------------------|--------------|-------------------|
| FSHF3802010A    | 0.004           | 100            | 0.031            | 0.17              | 2465            | 7500                                  | 2.6          | 35                |
| FSHF3802015A    | 0.006           | 150            | 0.031            | 0.17              | 1095            | 7500                                  | 5.6          | 30                |
| FSHF3802020A    | 0.008           | 200            | 0.031            | 0.17              | 616             | 7500                                  | 10           | 30                |
| FSHF3802025A    | 0.010           | 250            | 0.031            | 0.17              | 395             | 7500                                  | 18           | 30                |
| FSHF3802040A    | 0.015           | 380            | 0.038            | 0.17              | 245             | 7500                                  | 71           | 30                |
| FSHF3802050A    | 0.020           | 500            | 0.038            | 0.17              | 120             | 7500                                  | 143          | 30                |

## 495 FLANGE MOUNT SCREEN

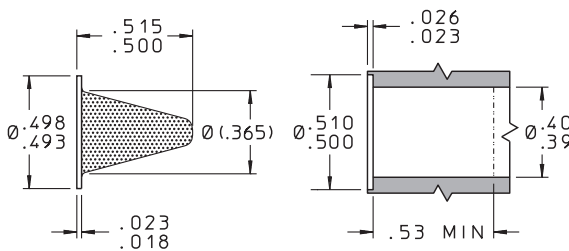

| LEE PART NUMBER | HOLE SIZE (in.) | HOLE SIZE (µm) | OPEN AREA (in.²) | TOTAL AREA (in.²) | NUMBER OF HOLES | BURST / COLLAPSE PRESSURE (psid min.) | ROB** NUMBER | LOHM* RATE (nom.) |
|-----------------|-----------------|----------------|------------------|-------------------|-----------------|---------------------------------------|--------------|-------------------|
| FSHF4952010A    | 0.004           | 100            | 0.06             | 0.32              | 4775            | 7500                                  | 5.1          | 20                |
| FSHF4952015A    | 0.006           | 150            | 0.06             | 0.32              | 2120            | 7500                                  | 11           | 20                |
| FSHF4952020A    | 0.008           | 200            | 0.06             | 0.32              | 1190            | 7500                                  | 20           | 20                |
| FSHF4952025A    | 0.010           | 250            | 0.06             | 0.32              | 765             | 7500                                  | 34           | 20                |
| FSHF4952040A    | 0.015           | 380            | 0.07             | 0.32              | 395             | 7500                                  | 115          | 20                |
| FSHF4952050A    | 0.020           | 500            | 0.07             | 0.32              | 225             | 7500                                  | 268          | 20                |

## 670 FLANGE MOUNT SCREEN

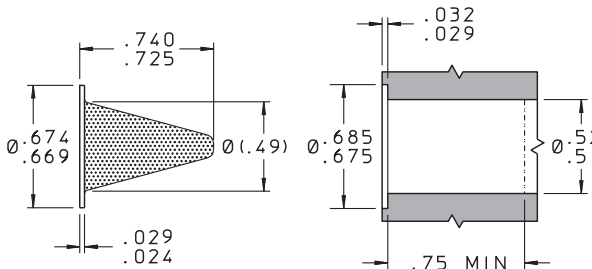

| LEE PART NUMBER | HOLE SIZE (in.) | HOLE SIZE (µm) | OPEN AREA (in.²) | TOTAL AREA (in.²) | NUMBER OF HOLES | BURST / COLLAPSE PRESSURE (psid min.) | ROB** NUMBER | LOHM* RATE (nom.) |
|-----------------|-----------------|----------------|------------------|-------------------|-----------------|---------------------------------------|--------------|-------------------|
| FSHF6702010A    | 0.004           | 100            | 0.11             | 0.62              | 8755            | 7500                                  | 9.3          | 10                |
| FSHF6702015A    | 0.006           | 150            | 0.11             | 0.62              | 3890            | 7500                                  | 20           | 10                |
| FSHF6702020A    | 0.008           | 200            | 0.11             | 0.62              | 2190            | 7500                                  | 37           | 10                |
| FSHF6702025A    | 0.010           | 250            | 0.11             | 0.62              | 1400            | 7500                                  | 63           | 10                |
| FSHF6702040A    | 0.015           | 380            | 0.14             | 0.62              | 790             | 7500                                  | 230          | 10                |
| FSHF6702050A    | 0.020           | 500            | 0.14             | 0.62              | 445             | 7500                                  | 530          | 10                |

\* The Lohm is a measure of flow resistance. Example: One Lohm will permit a flow of 100 GPM of water at 25 psid at 80°F.

\*\* The ROB Number indicates the relative resistance to blockage when comparing one screen to another. The higher the ROB Number, the greater the resistance to blockage.

Additional information can be found at [www.theleeco.com](http://www.theleeco.com) or by contacting your local Lee Sales Engineer.