

REV	DATE	BY	DESCRIPTION
A	12/14/11	DKR	INITIAL DRAWING RELEASE

DWG. NO.  
**LSIX1001450A**

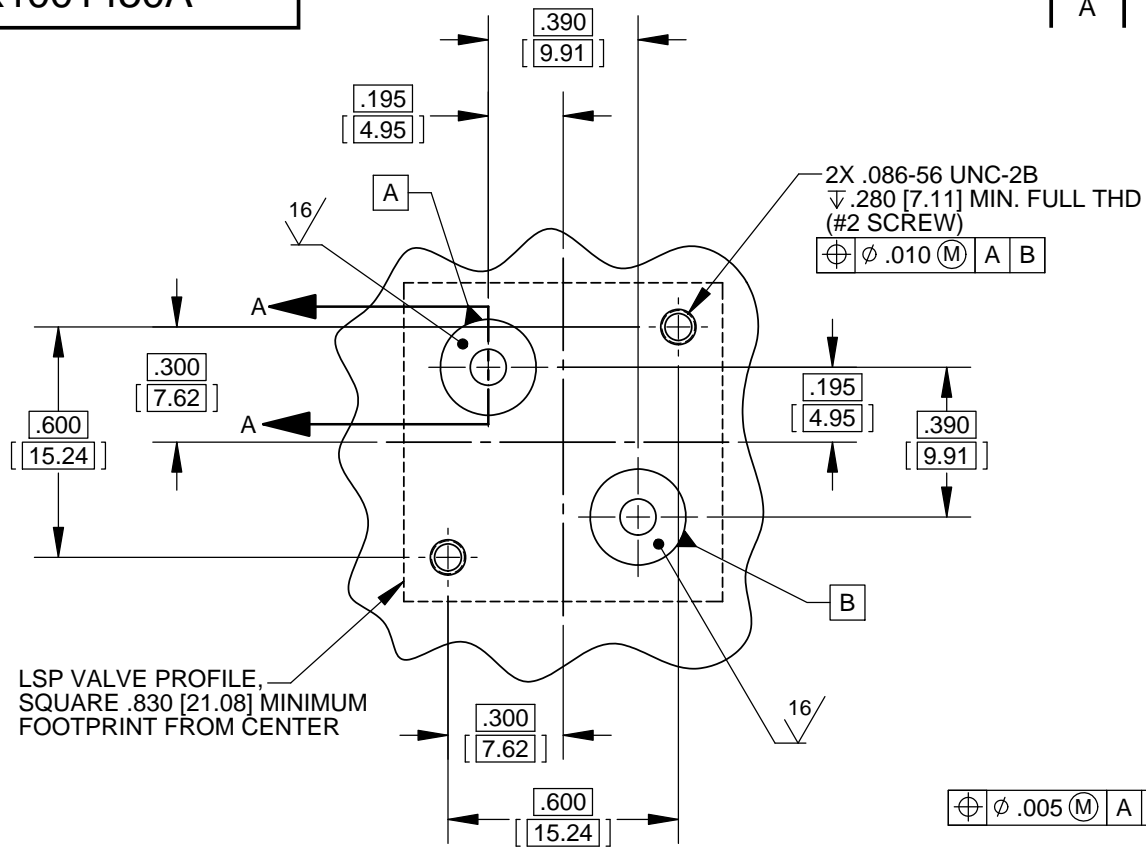

**PROPRIETARY ITEM**  
 This document contains proprietary information and is submitted upon the express condition that the information contained herein will not be used directly or indirectly in any way detrimental to the interests of the Lee Company, and/or in violation of regulation DAR 7-104.9 (a) (1 July 1974), et seq.

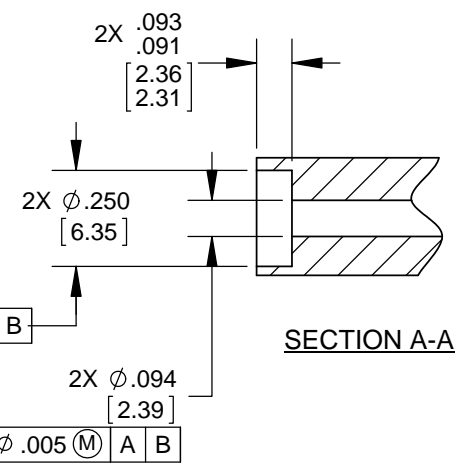

- NOTES:**  
 1. FOR USE WITH LEE LSP SERIES, 2-WAY N.C. VALVE.  
 2. RECOMMENDED DIMENSIONS UNLESS OTHERWISE SPECIFIED ON PARENT DRAWING

-FMF- THE LEE CO. ESSEX, CT	
MODEL NO. LSIX1001450	REV. 03
REF. NO.	

DO NOT SCALE DRAWING UNLESS OTHERWISE SPECIFIED DIMENSIONS ARE IN INCHES [mm] .XX ± .015 [0.38] .XXX ± .005 [0.13] .XXXX ± .001 [0.025] ANGLES ± 2° INT CORNER R. .01 [0.25] MAX EXT CORNER R. .01 [0.25] MAX SURFACE FINISH 63 √ [1.60]
THIRD ANGLE PROJECTION

DRAWN	DKR	12/14/11
CHK'D	KE	12/20/11
APP'D	BWH	12/20/11
MATERIAL		
NOTES AND DIMENSIONS SHOWN HEREON ARE FOR INSPECTION IDENTIFICATION ONLY. ALL MANUFACTURING RIGHTS ARE RESERVED.		

TITLE MOUNTING BOSS-LSP 2-WAY N.C			
		The Lee Company 55 Bokum Rd., Essex, Ct 06426	
SIZE A	CODE IDENT NO ONZR4	DWG. NO. LSIX1001450A	REV A
SCALE 2:1		SHEET 1 OF 1	

SPG SWAL\_2008-03-06