

LEE IMH Chek™ Valve - 6.5 mm CCPI Series Press-In

The Lee Company's new 6.5 mm Press-In Chek™ is the latest addition to our line of miniature cartridge-style check valves specifically designed for installation into plastics. This new valve offers more than twice the flow capacity over the existing 4.5 mm model. The valve features all stainless steel construction, providing compatibility with a wide range of fluids and gases.

Its unique barbed design provides easy "press-in" installation, ensures retention and prevents any by-pass leakage around the valve. A high-quality metal to metal seat provides low leakage and a highly repeatable cracking pressure. This robust design and 100% functional testing ensures consistent long term performance.

- 100% Tested
 - Eliminates Rework
- Bidirectional Installation
 - Provides Forward or Reverse Flow Capabilities
 - Design Flexibility
- Press-in Design
 - Simple Installation
- Leak Tight
 - Efficient System Performance



ACTUAL SIZE

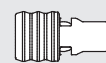

(As Installed)

CHEK VALVE

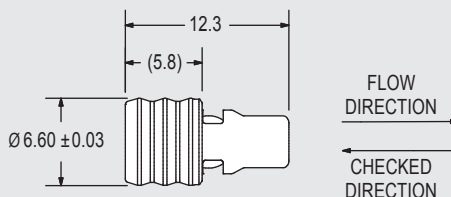

INSTALLATION HOLE

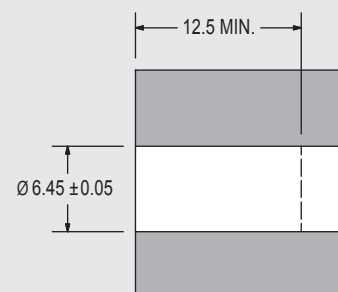

All dimensions in millimeters, except where noted.

ΔP vs. Flow on Water @80°F (27°C)

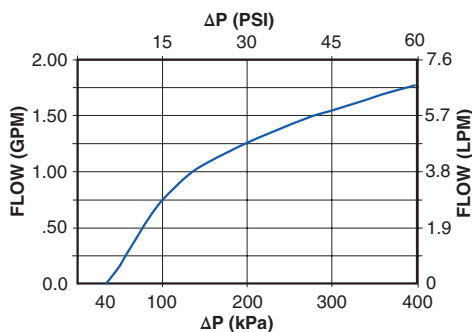

Flow Curve for 40 kPa Valve

PERFORMANCE

- Lohm Rate: 75 Lohms*
- Leakage: 20 sccm/min. (max.) @ 172 kPa (25 psid) on air
1 Drop/min. (max.) on water
- Materials: Body, Cage, Ball and Spring are Stainless Steel.

The valve's maximum working pressure is dependent on housing material, configuration and operating conditions.

* Lohm is a measure of flow resistance. See back page for more information.

LEE PART NUMBER	CRACKING PRESSURE
CCPI6510000S	0 kPa (No Spring)
CCPI6510004S	4 ± 3 kPa (0.6 ± 0.4 psid)
CCPI6510007S	7 ± 5 kPa (1 ± 0.7 psid)
CCPI6510014S	14 ± 5 kPa (2 ± 0.7 psid)
CCPI6510040S	40 ± 15 kPa (6 ± 2.2 psid)
CCPI6510069S	69 ± 17.3 kPa (10 ± 2.5 psid)
CCPI6510100S	100 ± 15 kPa (14.5 ± 2.2 psid)

LEE PART NUMBER	CRACKING PRESSURE
CCPI6510150S	150 ± 22.5 kPa (21.8 ± 3.3 psid)
CCPI6510200S	200 ± 30 kPa (29 ± 4.4 psid)
CCPI6510250S	250 ± 37.5 kPa (36.3 ± 5.4 psid)
CCPI6510300S	300 ± 45 kPa (43.5 ± 6.5 psid)
CCPI6510350S	350 ± 52.5 kPa (50.8 ± 7.6 psid)
CCPI6510400S	400 ± 60 kPa (58 ± 8.7 psid)
CCPI6510500S	500 ± 75 kPa (72.5 ± 10.9 psid)

LEE IMH Chek™ Valve - 6.5mm CCPI Series Press-In

SIMPLE TO INSTALL

To install, simply press the valve into a plastic installation hole until the valve is flush minimum with the top of the installation hole.

The valve can be installed in either direction, providing forward or reverse flow capabilities. Lee installation tools for each flow orientation are available as follows: Installation Tool Part

FORWARD FLOW INSTALLATION

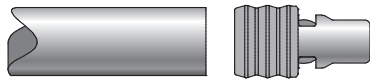

REVERSE FLOW INSTALLATION

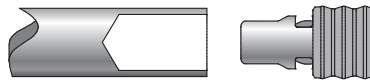

Number: CCRT0056802S for reverse flow orientation installations, Tool Part Number: CCRT0086564S for forward flow orientation installations.

† These valves can be pressed directly into plastics that have sufficient elongation such as Nylon, Polyethylene, Polypropylene, Acetal and PEEK.

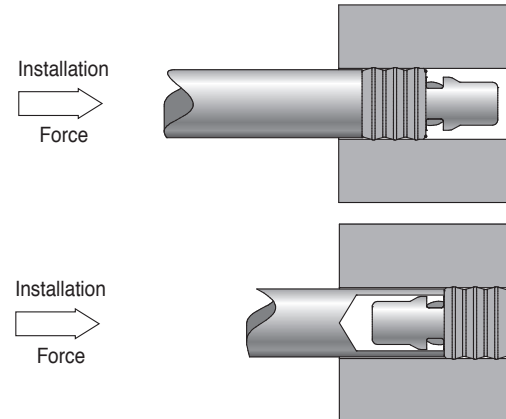

† For installation into other plastics contact your Lee Sales Engineer for more information. CCPI Series Check Valves are not designed to be pressed into metal.

LOHM LAWS

LOHMS LAWS (liquids)

Every engineer will be interested in our simple system of defining the fluid resistance of Lee hydraulic components.

Just as the OHM is used in the electrical industry, we find that we can use a liquid OHM or "Lohm" to good advantage on all hydraulic computations.

When using the Lohm system, you can forget about coefficients of discharge and dimensional tolerances on drilled holes. These factors are automatically compensated for in the Lohm calculations, and confirmed by testing each component to establish flow tolerances. The resistance to flow of any fluid control component can be expressed in Lohms.

The Lohm has been selected so that a 1 Lohm restriction will permit a flow of 100 gallons per minute of water with a pressure drop of 25 psi at a temperature of 80° F.

LIQUID FLOW FORMULA

The following formulas are presented to extend the use of the Lohm laws to many different liquids, operating over a wide range of pressure conditions.

These formulas introduce compensation factors for liquid density and viscosity. They are applicable to any liquid of known properties, with minimum restrictions on pressure levels or temperature.

The units constant (K) eliminates the need to convert pressure and flow parameters to special units.

$$\text{Volumetric Flow Units } L = \frac{KV}{I} \sqrt{\frac{H}{S}} \quad \text{Gravimetric Flow Units } L = \frac{KV}{w} \sqrt{HS}$$

NOMENCLATURE

- L = Lohms
- S = Specific gravity*
- H = Differential pressure
- V = Viscosity compensation factor**
- I = Liquid flow rate: Volumetric
- w = Liquid flow rate: Gravimetric
- K = Units Constant – Liquid (see chart below)
- *S = 1.0 for water at 80°F.
- **V = 1.0 for water at 80°F.

(For other fluids and temperatures, contact your Lee Sales Engineer or visit us at www.leeimh.com)

LIQUID FLOW - UNITS CONSTANT K

VOLUMETRIC FLOW UNITS			
Flow Units	Pressure Units		
	psi	bar	kPa
GPM	20	76.2	7.62
L/min	75.7	288	28.8
ml/min	75700	288000	28800
in ³ /min	4620	17600	1760

GRAVIMETRIC FLOW UNITS			
Flow Units	Pressure Units		
	psi	bar	kPa
PPH	10000	38100	3810
gm/min	75700	288000	28800